

## Protecta FR Acrylic Steel Copper or Alupex - Bare Pipes in 100mm Concrete Floor Aperture 300x300mm or 100mm Linear Gap

### Installation Instructions

- Before installing Protecta® FR Acrylic ensure that the surface of all service penetrations and surrounding construction is free from all loose contaminants, dust and grease.
- Where Protecta® FR Acrylic is to be installed against surfaces that cannot tolerate direct contact; appropriate surface preparation should be made (contact Polyseam for guidance in these cases). For paints sensitive to sealing compounds, priming with a PVA primer is recommended.
- As Protecta® FR Acrylic is water based, in cases where corrosion protection is a problem; some metals may require a barrier between the sealant and the metal surface prior to this installation.
- When installing any backing material, cut this slightly oversize and insert into the gap ensuring a tight friction fit. Ensure correct depth is achieved.
- Fill the gap or joint with Protecta® FR Acrylic to the required depth.
- Apply the sealant generously to prevent air bubbles. Finish the bead with a moist spatula, pallet knife or brush.
- Protecta® FR Acrylic can be over-painted with most emulsion or alkyd (gloss) paints.

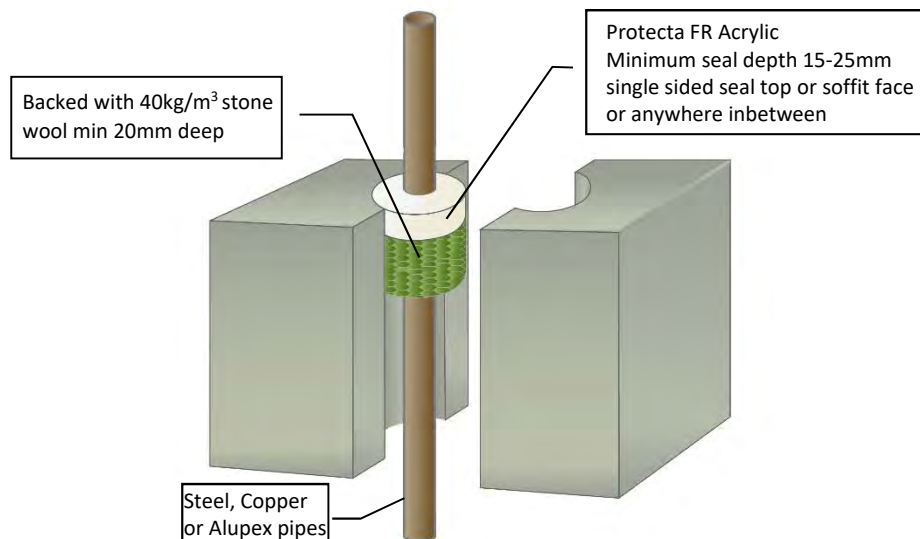

Services	Aperture	Sealant Depth	Classification
≤ Ø219mm Steel	300x300mm	15mm	FRR -/90/-
≤ Ø219mm Steel	300x300mm	25mm	FRR -/120/-
≤ Ø324mm Steel	300x300mm	25mm with 48mm stone wool	FRR -/120/-
≤ Ø219mm Steel	10mm annular	15mm	FRR -/240/-
≤ Ø219mm Steel	100mm linear gap	25mm	FRR -/120/-
≤ Ø54mm Copper or Steel	300x300mm	15mm	FRR -/90/-
≤ Ø54mm Copper or Steel	300x300mm	25mm	FRR -/120/-
≤ Ø15mm Copper or Steel	300x300mm	25mm with 48mm stone wool	FRR -/120/60
≤ Ø54mm Copper or Steel	10mm annular	15mm	FRR -/240/-
≤ Ø12mm Copper or Steel	10mm annular	15mm	FRR -/240/-
≤ Ø54mm Copper or Steel	100mm linear gap	25mm	FRR -/120/-
≤ Ø20mm Alupex	300x300mm	25mm with 48mm stone wool	FRR -/120/120
≤ Ø75mm Alupex	300x300mm	25mm with 48mm stone wool	FRR -/120/90

System/FPA Register ID# FC335

<b>Products</b>	Protecta FR Acrylic Stone wool
<b>Application</b>	Fire stopping of steel, copper or alupex pipes in rigid floors
<b>Construction</b>	Minimum floor thickness of 100mm and comprise aerated concrete or concrete with a minimum density of 650kg/m <sup>3</sup> .

### Fire & Sound classification

See table for FRR ratings and aperture sizes

Floor thickness may be reduced to a minimum of 100mm with FRR of system reduced to FRR of the floor.

These single-sided systems may be installed at any position within the floor.

ZERO smoke leakage up to 200Pa.

Sound reduction (seal only) STC 62



# Protecta®

Sheet size: Drawn date & no:

**A4**

24/5/21

Scale:

**NTS**

Drawn by:

K.B